

Notice Type: SAFE Notice

Location: Morandoo Yard

Subject Title: Change in Operational Control of Morandoo Yard

Corridor/Line: Hunter Valley

Control Board: Port Waratah, Terminal Coordinator

Kilometrage: 166.924

Effective From: 19/08/2025 Time: 0900 hrs

Reference Documents:

Network Information Book: OGW-30-14

General Details / Operating Condition:

Effective from 0900 hours Tuesday 19th August 2025, ARTC will take over from Pacific National, the management of operational Rail Traffic entry, exit, and movements within the Morandoo Exchange Shunting Yard:

Additionally, new advisory signage will be installed at:

- City end – 166.425km (112 Points)
- Country end – 167.470km (119 Points)
- From OneSteel end – 167.247km (Operational Boundary – refer: IA1505)

Safeworking Arrangements:

All work must be carried out as per the appropriate ARTC Network Rules and Procedures.

As required an Infrastructure Booking Advice (ANRF 003) must be compiled as per ARTC NSW Rules & Procedures ANWT 312 Infrastructure Booking Advice ANPR 704 Using Infrastructure Booking Advice.

Additional Details:

This SAFE Notice will serve as an amendment to the Network Information Book (NIB).

Amendment to Network Information Book:**OGW-30-14 – Islington & Port Waratah (inc) to Sandgate (exc)****Section 2.6.5 Morandoo Exchange Sidings 166.924km**

DELETE: All current text.

REPLACE WITH: The Morandoo Exchange Sidings are connected to No.3 Arrival Road at 109 Points and No.1 Bullock Island Arrival Road at 119 Points.

Morandoo non-track circuited area is a shunting yard.

All Rail Traffic needs to be authorised by the ARTC Terminal Coordinator prior to any shunting taking place within these sidings, this is to ensure that no conflicting movements can occur.

Placing of Traffic in the Exchange Sidings

All Rail Traffic requiring use of Morandoo Exchange Sidings must advise the Hunter Bulk ARTC Terminal Coordinator of the requirement to place their service within the sidings, any shunting requirements, and when trains are ready to depart.

Rail Traffic Entering Morandoo Exchange Sidings

All Rail Traffic intending to enter the non-track circuited shunting yard must first have obtained authority from the ARTC Terminal Coordinator.

Contact with the ARTC Terminal Coordinator is required prior to arriving at the following location points:

- Advisory Board (at 112 Points)
- Advisory Board (at 119 Points)
- Advisory Board (Up Direction Rail Traffic coming from the OneSteel Siding)
- 653 STOP Board (Up Direction Rail Traffic at 109 Points).

Communications

ARTC Terminal Coordinators are responsible for authorising all rail traffic movements within the Morandoo Exchange Sidings.

Rail Traffic on approach is required to contact the ARTC Terminator Coordinator using the Port Admin radio channel prior to entry. All movement of rail traffic within Morandoo Exchange Sidings is controlled and authorised by two-way radio equipment.

Radio Channels used for Morandoo Exchange Sidings are detailed in Section 2.6.3.

The ARTC Terminal Coordinator must confer with the Network Controller before authorising and permitting any rail traffic movement towards the signalled territory.

NOTE: All movements directed by two-way radio does not relieve Rail Traffic and Competent Workers of their responsibility for ensuring that all points and signals are correctly set before commencing a shunting movement or a rail traffic movement.

The area controlled by the ARTC Terminal Coordinator is covered by the area in red on the below diagram.

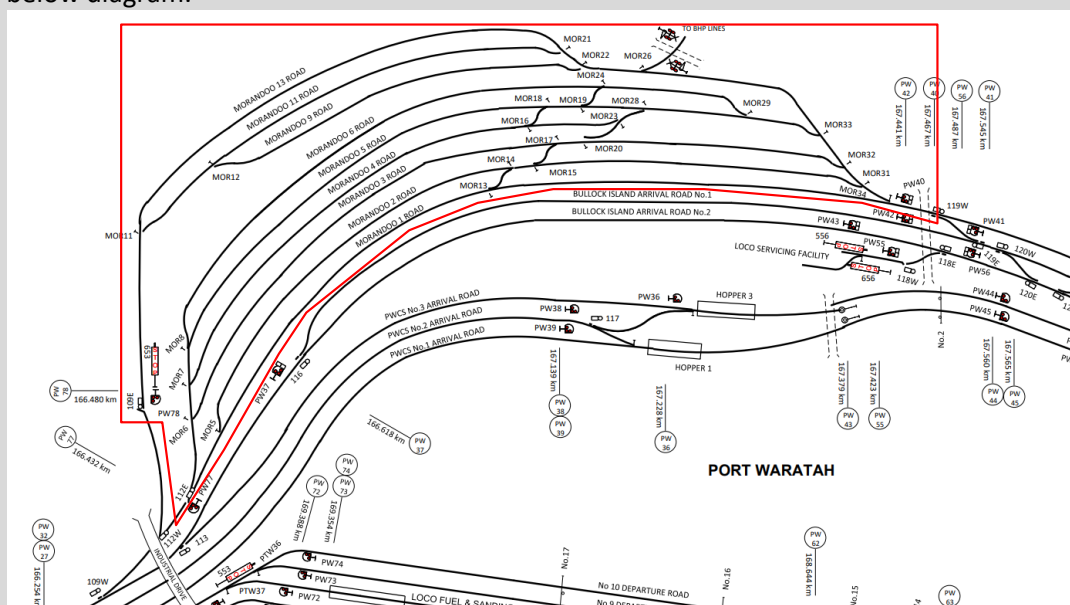

Closing Facilities

Facilities are provided at 119 Points to enable shunting movements to proceed in either direction over the 119 Points in Normal position, to and from the Shunting Neck without the Network Controller being required to set a route for each movement. Shunt Signals PW40 and PW41 apply.

Signage

Signage indicating the end of signalled authority is located upon entry to the Morandoo Exchange Sidings at:

- City end – 166.425km
- Country end – 167.470km
- From OneSteel end – 167.247km

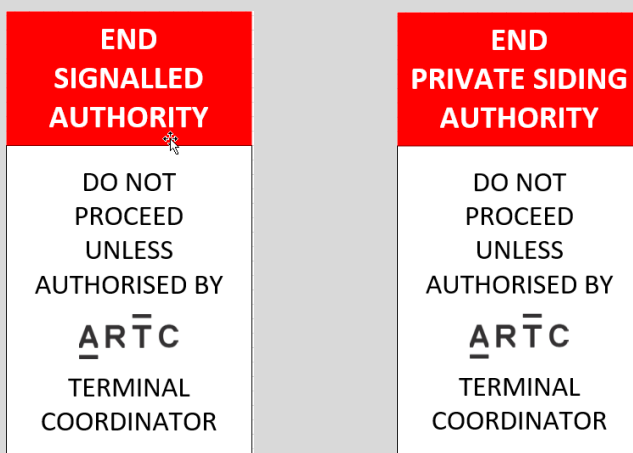

Examples of the signage

Roads and Ownership

Road	Length	Ownership / Management
1 Road	387 metres	ARTC – Terminal Coordinator
1 Grid	450 metres	ARTC – Terminal Coordinator
2 Road	401 metres	ARTC – Terminal Coordinator
2 Grid	335 metres	ARTC – Terminal Coordinator
3 Road	453 metres	ARTC – Terminal Coordinator
3 Grid	236 metres	ARTC – Terminal Coordinator
4 Road	415 metres	ARTC – Terminal Coordinator
4 Loop	65 metres	ARTC – Terminal Coordinator
5 Road	405 metres	ARTC – Terminal Coordinator
5 Loop	20 metres	ARTC – Terminal Coordinator
6 Road	492 metres	ARTC – Terminal Coordinator
6 Loop	90 metres	ARTC – Terminal Coordinator
9 Road	370 metres	ARTC – Terminal Coordinator
11 Road	340 metres	ARTC – Terminal Coordinator
13 Road	362 metres	ARTC – Terminal Coordinator

Recipients must ensure this Notice is circulated to and understood by all personnel affected by, or needing to know, its content.

This Notice must be issued to all affected Competent Workers.

Competent Workers who receive this Notice must follow the requirements.

Contact Details:

Contact: Mark Hocking – Delivery Support Manager NCCN Contact No. 0418 439 022

Approval:

Approved by: Manager Network Operations, Network Control Centre North Date: 13/08/2025